



holman & ASSOCIATES
Archaeological Consultants
"SINCE THE BEGINNING"

**3615 FOLSOM ST. SAN FRANCISCO,
CALIFORNIA 94110 415/550-7286**

Michael Cady
Union Community Partners, Inc.
6489 Camden Avenue Suite 204
San Jose, Ca 95120

RECEIVED JUL 12 2011

July 11, 2011

Dear Mr. Cady:

RE: CULTURAL RESOURCES STUDY OF THE WONG PROPERTY, APN-817-19-043,
MORGAN HILL, SANTA CLARA COUNTY, CALIFORNIA

At your request I have completed a cultural resources study of the above referenced project area located south of East Dunne Avenue in Morgan Hill, Santa Clara County, California. No evidence of historic or prehistoric cultural resources was discovered. This report contains a summary of information gained to date.

PROJECT DESCRIPTION

The proposed project area consists of a 4.83 L-shaped parcel of land located on the south side of East Dunne Avenue in Morgan Hill. Located on the Mt. Sizer U.S.G.S. map, the borders of the parcel are East Dunne Avenue on the north, housing bordering Marbella Court on the west, an open and cultivated field on the south, and housing found on the west and south sides of Pine Way on the eastern borders of the L. At the time of my field visit the property contained a house and adjacent buildings of recent origin bordering East Dunne, with the remainder of the property an open field which had been disced in the very recent past.

ARCHIVAL RESEARCH

Prior to the field inspection, this author completed an archaeological literature review at the Northwest Information Center (NWIC) located in Rohnert Park on June 27th, 2011 (NWIC file no. 10-1283). The property has not been surveyed formally, although there have been a number of small field studies within a quarter mile, none of them turned up cultural resources. There are no historic and/or prehistoric archaeological sites located inside the project borders, nor within a quarter mile of it.

WONG PROPERTY CULTURAL RESOURCES STUDY

FIELD INSPECTION

A visual inspection of the project area was conducted by this author on July 5th, 2011 by walking over the surface of the parcel in 20 foot transects. It was obvious that the field had been disced at some point in the late spring, making approximately 90% of the ground surface visible. The soils throughout are a uniformly gray to brown silty clay loam, containing abundant small water worn gravels of chert, sandstone and basalt. The ground was inspected for any evidence of Native American habitation or use: evidence of fires (ash, charcoal, fire altered rock or earth), concentrations of stone, bone, fresh water shellfish and artifacts of these materials.

FINDINGS/RECOMMENDATIONS

No evidence of historic or prehistoric cultural resources was discovered at any point inside the project borders. Samples of the artifact grade gravels (cherts and basalts) were inspected for signs of deliberate modification or use by Native Americans, but none were found. The few examples of fractured cherts were probably the result of discing of the field. No signs of fire and no concentrations of stone or bone were seen.

It is the opinion of this author that future development of this parcel will have no effect on historic or prehistoric cultural resources. The lack of visual indicators and the fact that the other small cultural resource studies on this side of Highway 101 have not turned up buried cultural resource deposits reinforces my opinion that this general part of Morgan Hill has a low potential for containing cultural resources. Because of the low potential, this report makes no recommendations for mechanical subsurface presence/absence testing, and does not recommend archaeological monitoring of upcoming construction related earthmoving activities.

Sincerely,



Miley Paul Holman

WONG PROPERTY (APN-817-19-043)

MORGAN HILL, SANTA CLARA COUNTY, CALIFORNIA
MT. SIZER AND MORGAN HILL U.S.G.S. MAP

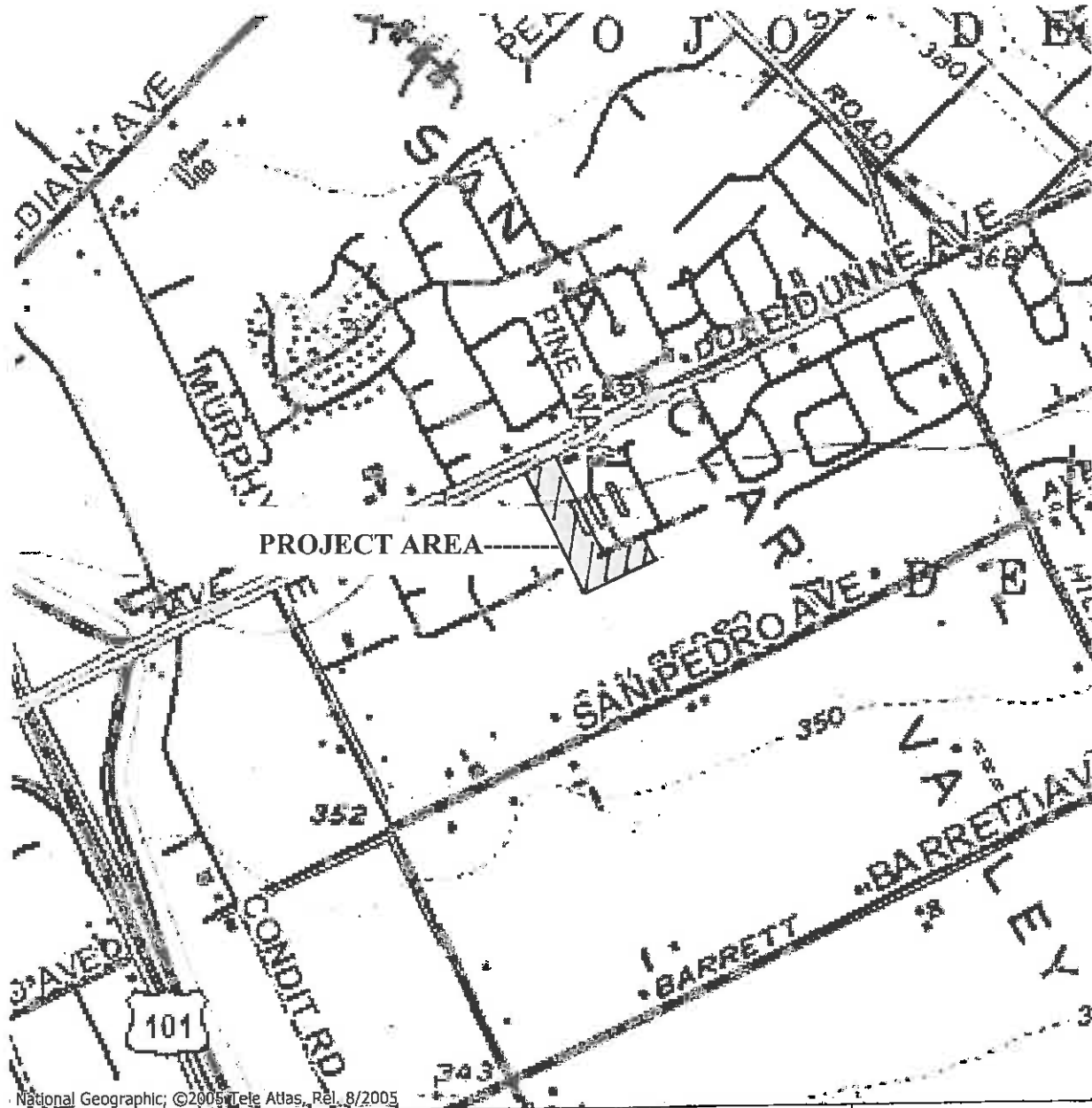

National Geographic; ©2005 Tele Atlas, Rel. 8/2005

°38.000' W

WGS84 121°37.000' W

0.0 0.1 0.2 0.3 0.4 miles

0.0 0.1 0.2 0.3 0.4 0.5 0.6 km

