

L:\Projects\Harry\221005.1.MH Morgan Hill & City Ventures @ Gateway Center\DWG\221005 General Plan Amendment.dwg - 10/20/2021 4:41 PM - Plotted 10/20/2021 4:42 PM by Kristian Wallace

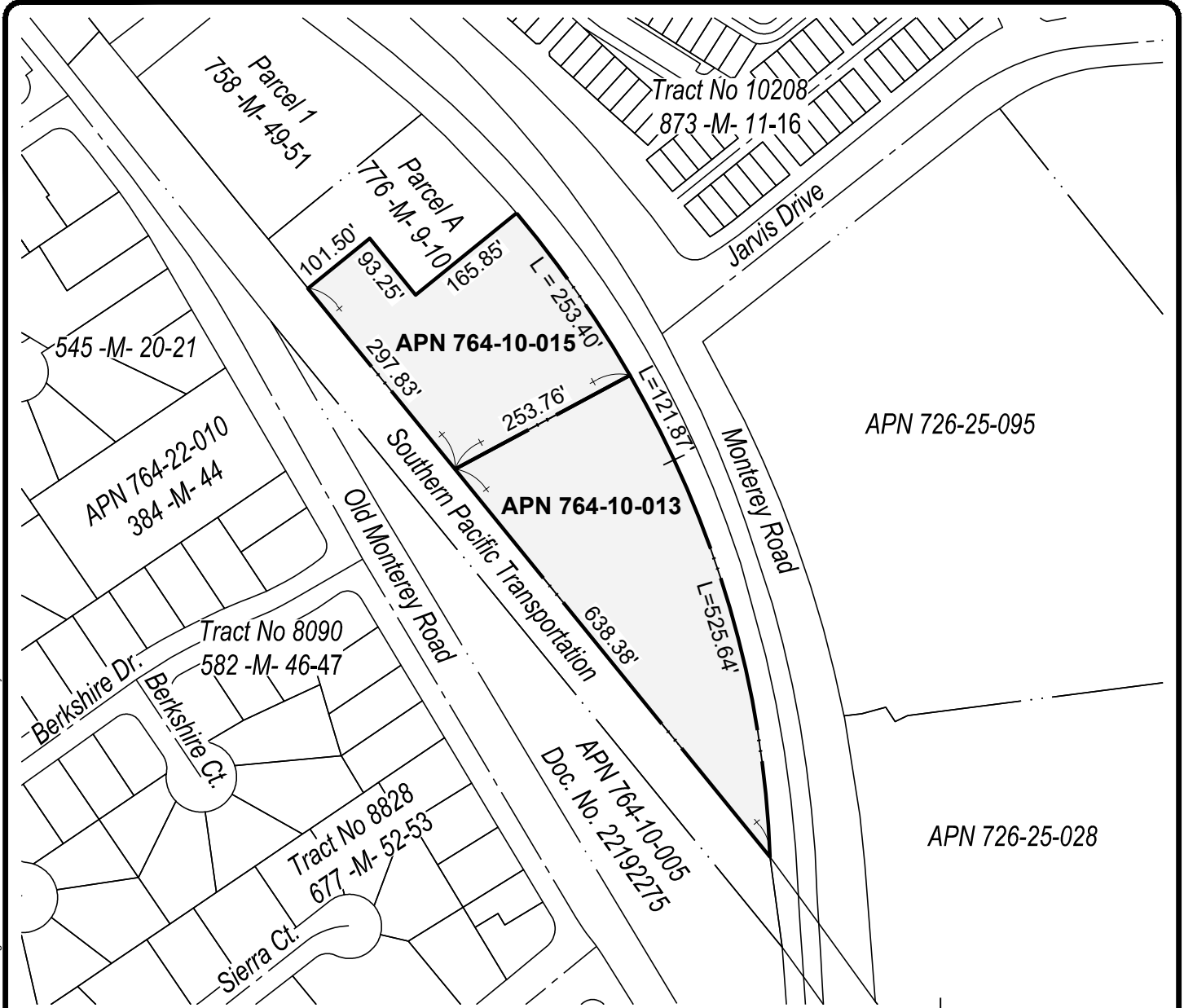

Legend

- Property Boundary
- General Plan Change Area
- From:** Commercial
- To:** Mixed Use Flex (MUF)

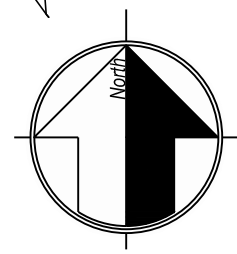

Scale: 1"=200'

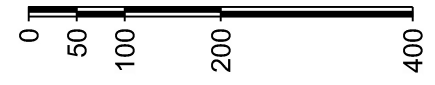

Proposed General Plan Amendment to the City of Morgan Hill entitled "City Ventures Homebuilding, LLC"



MH engineering Co.

16075 VINEYARD BOULEVARD MORGAN HILL, CA 95037 (408) 779-7381

SCALE: 1" = 200'	JOB #: 221005	SHEET
DRAWN BY: MiguelM	DATE: October 20, 2021	1 of 1